

57 Bibury Road Hall Green B28 0HG

Offers Over £300,000



A FOUR BEDROOM centrally heated semi-detached property with SOLAR PANELS TO REDUCE ENERGY COSTS (owned by property with no freehold issues), two separate reception rooms, kitchen with separate utility room, LARGE REAR GARDEN and front driveway giving substantial OFF ROAD PARKING.

Please make sure you submit any offer for this property by email to: offers@clivetannerwyatts.co.uk

Please supply in the email:

- Full names and address of the people making the offer
- Best contact telephone numbers
- The offer
- Amount of deposit you have
- Amount of mortgage you will need

If you need to follow up your offer at any point please text our textline: 07519711864

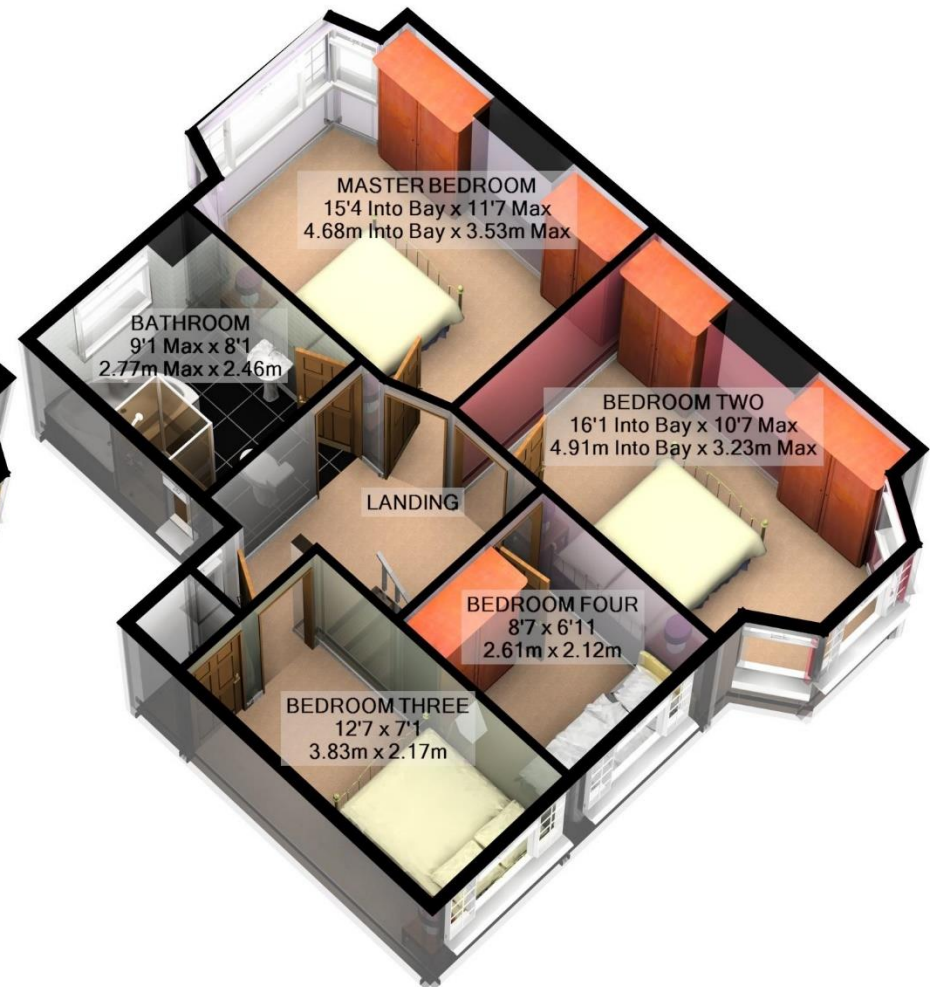
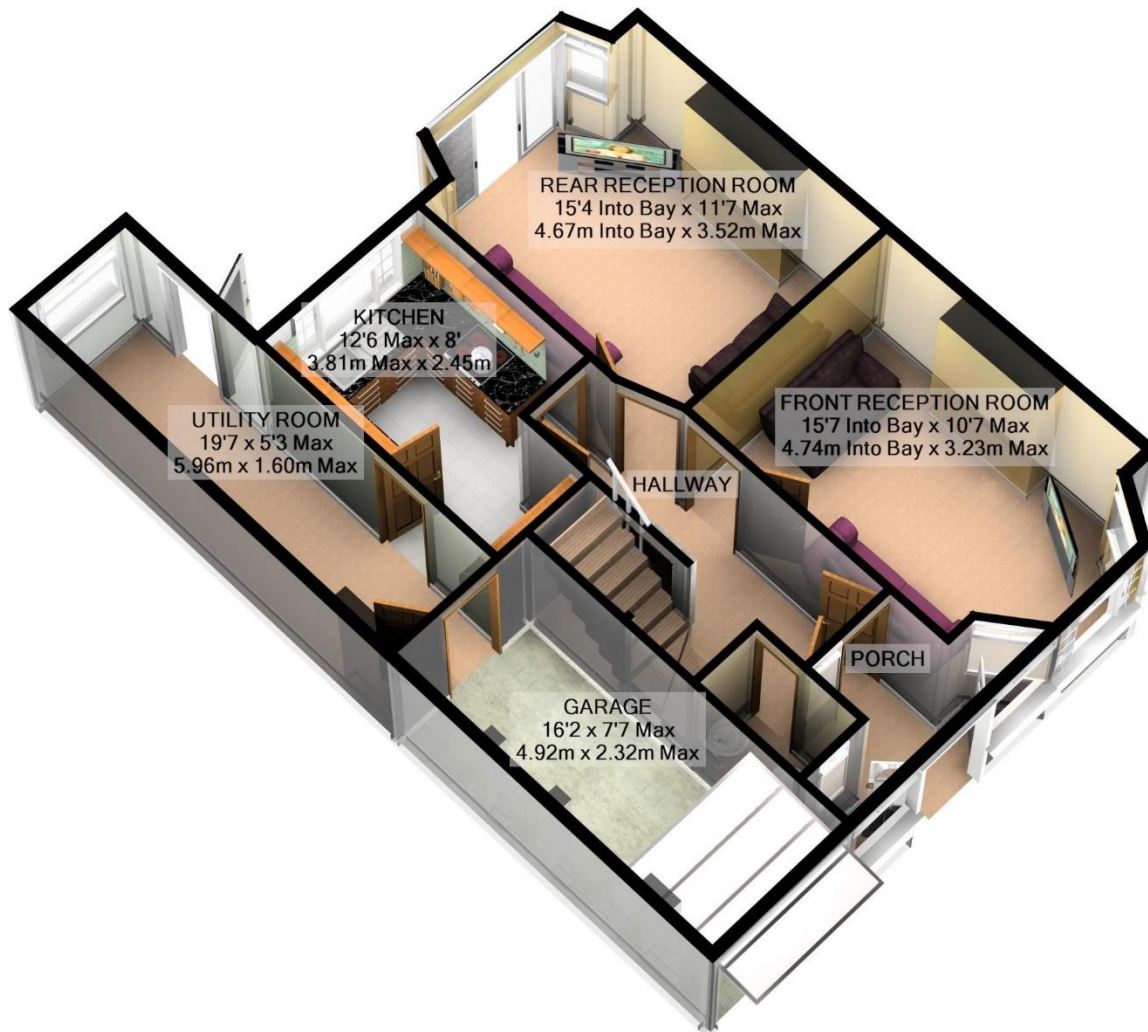

GROUND FLOOR
APPROX. FLOOR
AREA 736 SQ.FT.
(68.4 SQ.M.)

1ST FLOOR
APPROX. FLOOR
AREA 605 SQ.FT.
(56.2 SQ.M.)

BIBURY ROAD, HALL GREEN B28 0HG - CLIVE TANNER WYATTS 0121 778 1318
TOTAL APPROX. FLOOR AREA 1341 SQ.FT. (124.5 SQ.M.)

For illustrative purposes only. Decorative finishes, fixtures, fittings and furnishings do not represent the current state of the property. Measurements are approximate. Not to scale
Made with Metropix ©2019

