

674 Stratford Road Sparkhill B11 4AS Offers Over £200,000



A large centrally heated and double glazed (where shown) property, with **FOUR DOUBLE BEDROOMS**, **THREE SEPARATE RECEPTION ROOMS**, **BREAKFAST KITCHEN**, **UPSTAIRS BATHROOM** and rear garden.

Please make sure you submit any offer for this property by email to: offers@clivetannerwyatts.co.uk

Please supply in the email:

- Full names and address of the people making the offer
- Best contact telephone numbers
- The offer
- Amount of deposit you have
- Amount of mortgage you will need

If you need to follow up your offer at any point please text our textline: 07519711864

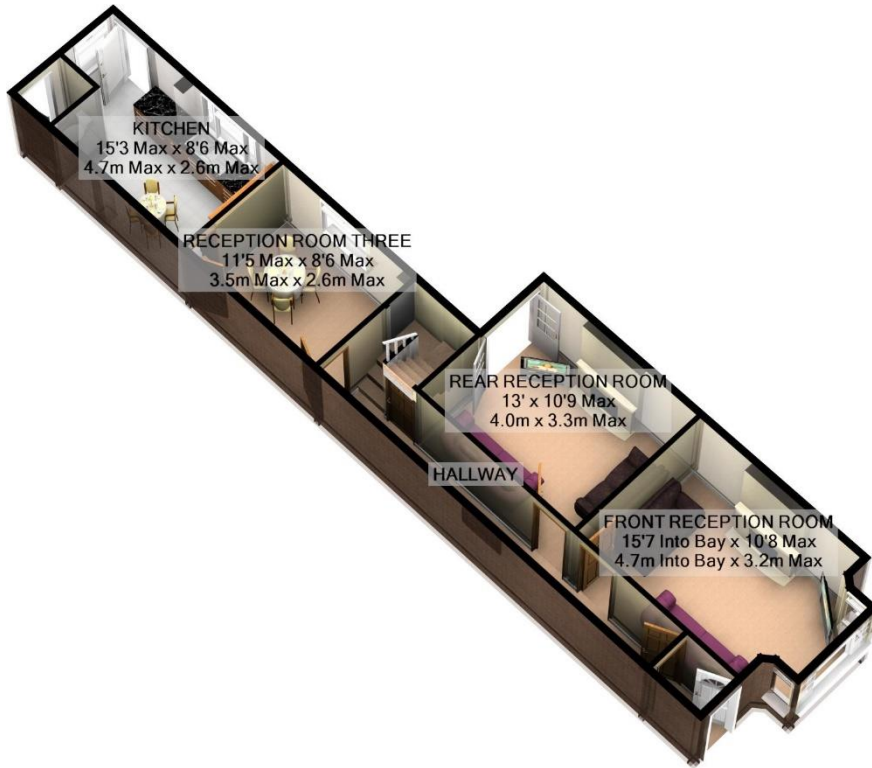

GROUND FLOOR
APPROX. FLOOR
AREA 650 SQ.FT.
(60.4 SQ.M.)

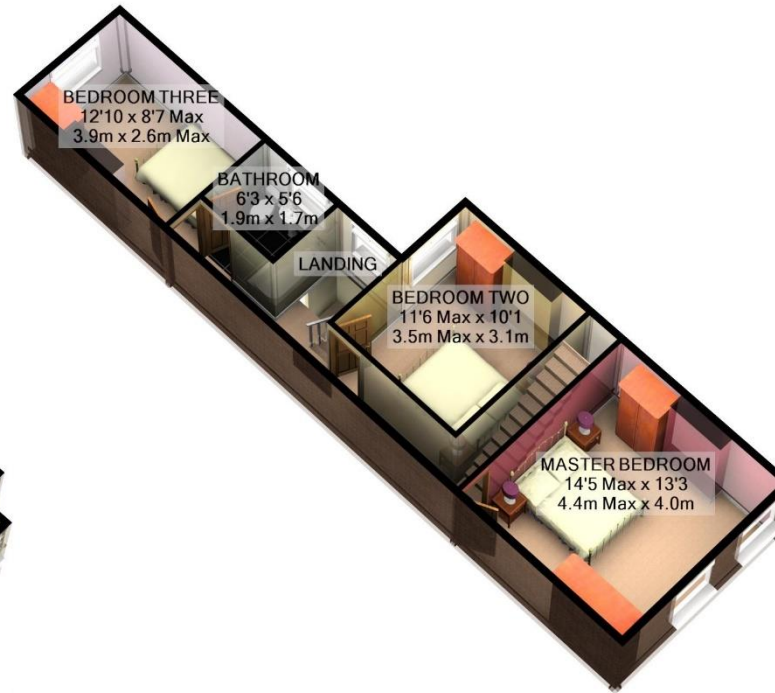

1ST FLOOR
APPROX. FLOOR
AREA 556 SQ.FT.
(51.7 SQ.M.)

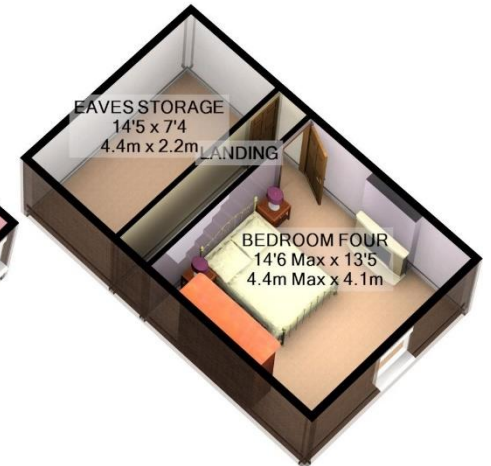

2ND FLOOR
APPROX. FLOOR
AREA 322 SQ.FT.
(29.9 SQ.M.)

STRATFORD ROAD, SPARKHILL B11 4AS - CLIVE TANNER WYATTS 0121 778 1318
TOTAL APPROX. FLOOR AREA 1528 SQ.FT. (142.0 SQ.M.)

For illustrative purposes only. Decorative finishes, fixtures, fittings and furnishings do not represent the current state of the property. Measurements are approximate. Not to scale
Made with Metropix ©2018

